

Roger™ Table Mic

Technical Data



Roger Table Mic is a microphone for working adults with a hearing loss who participate in small and large meetings.

This unique product picks up speech at a meeting in a way that no other product on the market does. For larger meetings it's possible to use several Roger Table Mics. With outstanding operating time and the included remote it's convenience at its best.

Roger Table Mic features

- Audio processing fine tuned for meetings
- Easy coverage of large meetings with MultiTalker Network
- Remote control for increased convenience
- Audio input for connection to multimedia devices
- 20 hours of operating time

What is Roger

Roger is the new digital standard that bridges the understanding gap, in noise and over distance, by wirelessly transmitting the speaker's voice directly to the listener.

Description

- ① Indicator light (LED)
- ② Microphone
- ③ On/off/mute
- ④ Connect
- ⑤ Charging input (micro-USB)
- ⑥ Audio input (3.5 mm / 1/8 inch jack)
- ⑦ Mute off
- ⑧ Mute on
- ⑨ Screw
- ⑩ Battery cover

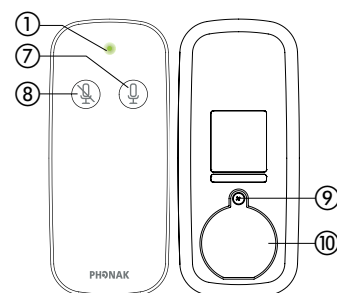
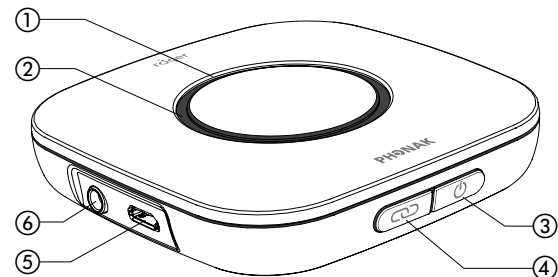

General data

Type:	Roger microphone
Dimensions (L x W x H):	78 x 78 x 16 mm / 3.1 x 3.1 x 0.6 inches
Weight:	103 g / 0.23 lbs
Operating conditions:	Temperature should not exceed the limit values of 0° to +40° Celsius / +32° to +104° Fahrenheit and relative humidity of <95% (non condensing)
Transport and storage conditions:	During transport or storage, the temperature should not exceed the limit values of -10° to +60° Celsius / +14° to +140° Fahrenheit and relative humidity of 90% for a long period
Battery:	Type: Lithium Polymer Capacity: 1200 mAh Voltage: 3.7V
Operating time:	20 hours
Power supply (Roger Table Mic):	Voltage input: 100-240V Voltage output: 5 VDC / 1A Connector: micro-USB Cable length: 1.3 m / 4.2 feet
Power supply (Roger Table Mic 2x)	Voltage input: 100-240V Voltage output: 5 VDC / 2A Connector: micro-USB Cable length: 1.3 m / 4.2 feet

Microphone characteristics

Microphone:	Omni directional microphone
-------------	-----------------------------

Roger characteristics

Transmission technology:	2.4 GHz including adaptive automatic frequency hopping
Power emission:	63 mW
Operating range:	20 meters / 66 feet (typical) 40 meters / 130 feet (ideal conditions)

Roger system data (Connect)

Frequency (Roger microphone to Roger receiver):	2.4 GHz
Connect operating range:	10 cm / 3.9 inches

Roger network

Compatible Roger receivers:	All personal Roger receivers
Number of Roger receivers:	Unlimited
Compatible Roger microphones:	Roger EasyPen, Roger Pen and Roger Clip-On Mic
Number of Roger microphones:	Up to 10

Audio characteristics

Audio bandwidth:	100 Hz – 7.3 kHz
------------------	------------------

Standards

El. Safety:	IEC / EN 60950-1
Radiocom 2.4 GHz:	EN 300 328
EMC:	EN 301.489-1,-3,-9,-17