

# Roger MyLink

1.1 (02)

Technical Data



Roger MyLink is a universal inductive neckloop receiver that brings industry-leading speech-in-noise performance to any person with hearing loss.

Simply connect Roger MyLink with a Roger wireless microphone. Roger MyLink is compatible with all hearing instruments and cochlear implants that feature a T-Coil, including ITE and micro sized BTEs.

## Roger MyLink features

- Additional adaptive gain
- Effective stand-by mode
- Rechargeable built-in battery
- Over 10 hours operating time
- Headphone output
- Check to read device data via Roger inspiro
- Link quality measurement

## What is Roger

Roger is the new digital standard that bridges the understanding gap, in noise and over distance, by wirelessly transmitting the speaker's voice directly to the listener.

## Indicator light

- ① Battery almost exhausted
- ② Battery completely exhausted
- ③ Charging in progress
- ④ Charging completed
- ⑤ Volume control: minimum / maximum position
- ⑥ Volume control: middle position

## Description

- ① On / off
- ② Volume control
- ③ Detachable side of the neckloop
- ④ Fixed side of the neckloop
- ⑤ Indicator light (LED)
- ⑥ Charging socket
- ⑦ Headphone socket (2.5 mm)

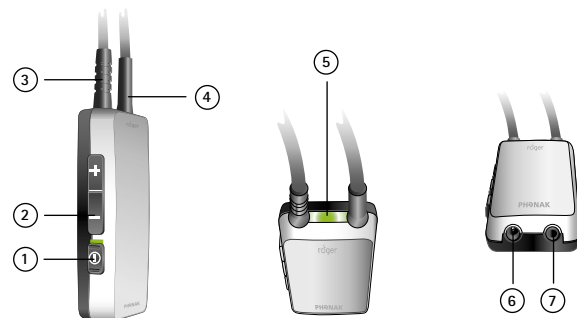

## General data

Type:	Universal inductive Roger receiver Operates with Roger microphones
Dimensions without neckloop (L x W x H):	66 x 29 x 12 mm / 2.60 x 1.14 x 0.47 inch
Length of standard loop:	760 mm / 30 inches
Length of short loop:	560 mm / 22 inches
Weight (including standard loop):	42 g / 0.09 lb
Operating conditions:	The product has been designed for trouble-free operation without restrictions when used as intended, unless otherwise stated in the user guide. 0° to +40° Celsius, +32° to +104° Fahrenheit and relative humidity < 95% (non condensing)
Transport and storage conditions:	-20° to +60° Celsius, -4° to +140° Fahrenheit and relative humidity of 90% for a long period of time

## Roger characteristics

Frequency:	2.4 GHz including adaptive automatic frequency hopping
Transmission delay:	< 20 ms
Antenna:	Built-in antenna
Backlink RF power:	< 10 mW / MHz

## Audio characteristics

Audio bandwidth:	100 Hz – 7.0 kHz
Distortion:	< 2% for fmod = 1 kHz
Magnetic field strength:	1.25 A / m 150 mm above the center loop (transmitter in compression, fmod = 1 kHz, surrounding noise level < 58 dB SPL)
Additional adaptive audio gain:	Up to 20 dB
Level of headphone output:	150 mV at 32 Ohm (transmitter in compression, fmod = 1 kHz, surrounding noise level < 58 dB SPL)
Headphone connector:	Jack 2.5 mm / 0.1 inch

## Power and battery information

<b>Battery information:</b>	
Type:	Lithium Polymer 3.7 V DC Embedded, not removable Capacity: 250 mAh (typ.) Charging time: 2 hours (typ.)
Operating time:	>10 hours
<b>Charging information:</b>	
Input voltage:	7.5VDC, stabilized Circular connector, 1.1 / 3 mm, inner pole positive Input current: max. 260 mA The battery cannot be over-charged. It may become warm during charging

## Standards

Radiocom:	EN 300 440 FCC part 15.249
EMC:	EN 60601-1-2, EN 301 489 FCC part 15b
Safety:	EN 60601-1

